

CONSTRUCTION EXCELLENCE AWARD

The Award

The BCA Construction Excellence Award was introduced in 1986 to promote and enhance construction excellence in the industry. Into its 25th year of competition, it gives recognition to builders for achieving excellence in areas of management, technology and construction quality. To date, BCA has conferred 170 Awards and 169 Certificates of Merit.

Award Categories

- Commercial/Mixed Development Buildings
- Industrial Buildings
- Institutional Buildings
- Residential Buildings (S\$1200 / m² and Above)
- Residential Buildings (Below S\$1200 / m²)
- Small Buildings - S\$3 million to S\$10 million
- Civil Engineering Projects

Assessment Committee

Chairman

Mr Song Wee Ngee

BCA Board Member (2007-2011)
Managing Director
KTP Consultants Pte Ltd

Deputy Chairman

Mr Richard Hassell

BCA Board Member
Founding Director
WOHA Architects Pte Ltd

Members

Mr Eddie Wong

Mr Khor Thong Meng

Allgreen Properties Limited

Mr Ler Seng Ann

Urban Development Authority

Er. Ng Eng Kiong

Squire Mech Pte Ltd

Mr Paul Fok

Land Transport Authority

Mr Pek Lian Guan

Tiong Seng Contractors (Pte) Ltd

Mr Steven Low Kong Yen

ONG&ONG Pte Ltd

Dr Tan Guan

T.Y.Lin International Pte Ltd

Dr Ting Seng Kiong

Singapore Institute of
Technology

Mr Yap Tiem Yew

Housing & Development Board

Mr Yutaka Gozu

Shimizu Corporation

Mr Lam Siew Wah

Building and Construction
Authority

Mr Tan Tian Chong

Building and Construction
Authority

CONSTRUCTION EXCELLENCE AWARD

★ Award

Jurong Point 2 Shopping Centre / The Centris / Boon Lay Bus Interchange

(Commercial / Mixed Development Buildings Category)

Builder

Woh Hup (Private) Limited

Client

Prime Point Realty Development Pte Ltd

Principal Consultant

cgnArchitects Pte Ltd

Structural Consultant

Meinhardt Infrastructure Pte Ltd

M&E Consultant

Bescon Consulting Engineers Pte

Quantity Surveyor

Davis Langdon & Seah Singapore Pte Ltd

Construction Cost

S\$245.4 million

Construction Period

Phase 1 - 29.2 mths / Phase 2A - 37.0 mths / Phase 2B - 37.6 mths

Gross Floor Area

117,333 m²

Key Features

- Enhanced safety by using custom made external hanging safety screen rather than external scaffolding and won numerous safety awards, i.e. WSH Best Practice Awards 2007, SHARP 2007, SHARP 2008 and BCA Design & Engineering Excellence Award 2010 (Merit).
- Used secant pile wall as temporary earth retaining structure (TERS) to limit surface settlement, noise pollution and vibration due to close proximity to Jurong Point Shopping Centre and Boon Lay MRT Station.
- Enhanced productivity by extensively using system formworks and precast elements such as aluminium table form for floor slabs, jump forms for core walls, precast beams for loft units, precast slabs, precast bay windows, etc.

★ Award

7 & 9 Tampines Grande

(Commercial / Mixed Development Buildings Category)

Builder

Dragages Singapore Pte Ltd

Client

City Developments Limited

Architectural Consultant

Architects 61 Pte Ltd

Structural Consultant

LSW Consulting Engineers Pte Ltd

M&E Consultant

Conteem Engineers Pte Ltd

Quantity Surveyor

KPK Quantity Surveyors (Singapore) Pte Ltd

Construction Cost

S\$121.5 million

Construction Period

19.5 months

Gross Floor Area

33,587 m²

Key Features

- Winner of numerous green and sustainable awards such as BCA Green Mark Platinum Award in 2008, LEED CS 2.0 Gold Certification in 2010, etc.
- Enhanced productivity by using precast components in the building structure, such as precast slabs, perimeter beams, etc.
- A fast-track Design & Build Project which maximised productivity and achieved excellent workmanship quality through extensive usage of precast elements, prefabricated components and drywall system.

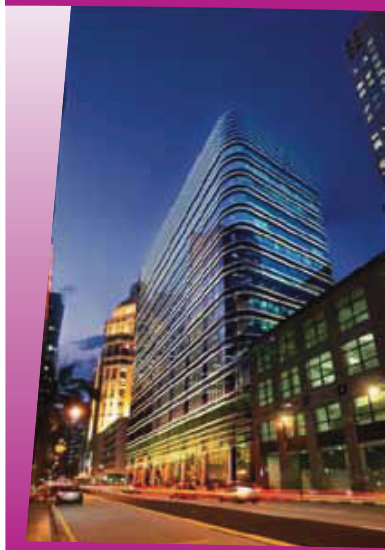

71 Robinson Road

(Commercial / Mixed Development Buildings Category)

Builder

Kajima Overseas Asia Pte Ltd

Client

Kajima-Lehman (Robinson) Development Pte Ltd

Principal Consultant

Ingenhoven Architekten

Architectural Consultant

Architects 61 Pte Ltd

Structural Consultant

RSP Architects Planners & Engineers (Pte) Ltd

M&E Consultant

Squire Mech Pte Ltd

Quantity Surveyor

Davis Langdon & Seah Singapore Pte Ltd

Acoustic Consultant

Acvion Acoustics Consultants Pte Ltd

Lighting Consultant

Project Lighting Design Pte Ltd

Construction Cost

S\$91.1 million

Construction Period

26.0 months

Gross Floor Area

26,035 m²

Key Features

- Achieved a high CONQUAS score of 91.9 for excellence in workmanship quality.
- Winner of various safety awards such as ROSPA Gold Award in 2009, WSH SHARP in 2009 and BCA Design & Engineering Excellence Award 2010.
- Won the BCA Green Mark Gold Award in 2008 for incorporating numerous ecological designs such as low-E double glazing, motion sensors for lighting in toilets, etc.
- Enhanced productivity by using precast components in the structure, such as precast slabs, perimeter beams, etc.



Orchard Central

(Commercial / Mixed Development Buildings Category)

Builder

Woh Hup (Private) Limited

Client

Far East Organization

Principal Consultant

DP Architects

Structural Consultant

KTP Consultants Pte Ltd

M&E Consultant

Beca Carter Hollings & Ferner (S.E. Asia) Pte Ltd

Quantity Surveyor

KPK Quantity Surveyors (Singapore) Pte Ltd

Construction Cost

S\$296.0 million

Construction Period

31.0 months

Gross Floor Area

36,045 m²

Key Features

- Demonstrated excellence in overcoming constraint of its close proximity to major shopping complexes, hotels and Somerset MRT station, as well as the underpinning of Stamford Canal to build 2 levels of basement below it without disturbance to water flow.
- Used long span and cantilever pre-stressed beams to improve buildability and achieve cost reduction.

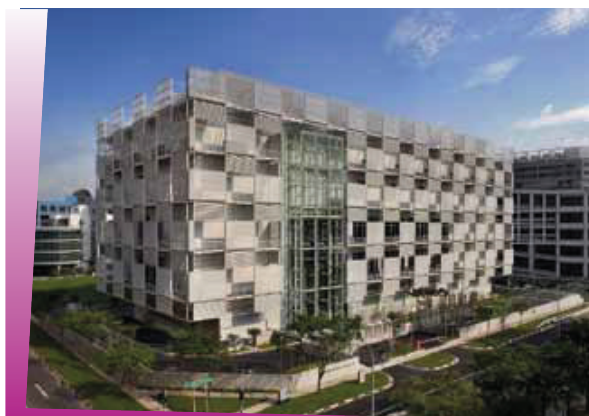

Credit Suisse Asia Pacific Regional Data Centre Project

(Industrial Buildings Category)

Builder

Obayashi Corporation

Client

Credit Suisse

Architectural Consultant

AWP Pte Ltd

Structural Consultant

Parsons Brinckerhoff Pte Ltd

M&E Consultant

Meinhardt (Singapore) Pte Ltd

Quantity Surveyor

Turner & Townsend Pte Ltd

Project Manager

Meinhardt (Singapore) Pte Ltd

Construction Cost

S\$67.9 million

Construction Period

24.0 months

Gross Floor Area

14,154 m²

Key Features

- Winner of the BCA Green Mark Platinum Award in 2009.
- Boost productivity by using system formwork for RC Core wall, prefabricated rebar cages, etc.
- Enhanced safety and productivity by using 41m high boom lifts for installation of its façade.

CONSTRUCTION EXCELLENCE AWARD

★ Award



Duke-NUS Graduate Medical School Singapore

(Institutional Buildings Category)

Builder

China Construction (South Pacific)
Development Co Pte Ltd

Client

Duke-NUS Graduate Medical School Singapore

Principal Consultant

CPG Consultants Pte Ltd

Architectural Consultant

CPG Consultants Pte Ltd

Structural Consultant

CPG Consultants Pte Ltd

M&E Consultant

CPG Consultants Pte Ltd

Quantity Surveyor

CPG Consultants Pte Ltd

Project Manager

PM Link Pte Ltd

Construction Cost

S\$99.1 million

Construction Period

22.0 months

Gross Floor Area

26,590 m²

Key Features

- Demonstrated excellence in overcoming constraints from its close proximity to hospital buildings, safety concerns of the public and the busy traffic along College Road.
- Overcame the problem of limited site storage by adopting just-in-time (JIT) planning for installation of aluminium curtain wall and structural steel member.

★ Award

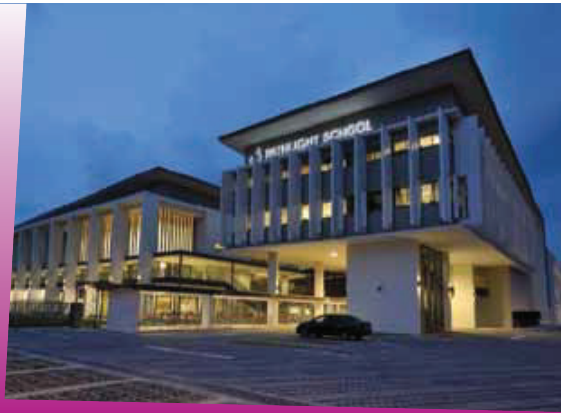

Pathlight School

(Institutional Buildings Category)

Builder

Kwan Yong Construction Pte Ltd

Client

Autism Resource Centre

Principal Consultant

W Architects Pte Ltd

Structural Consultant

WP Brown Pte Ltd

M&E Consultant

Parsons Brinckerhoff Pte Ltd

Quantity Surveyor

BEC Consultants

Project Manager

PM Link Pte Ltd

Construction Cost

S\$27.2 million

Construction Period

18.0 months

Gross Floor Area

16,542 m²

Key Features

- Winner of the BCA Green Mark Gold Award in 2008.
- Used modular components for better productivity and quality.

★ Award



City Square Residences

(Residential Buildings - S\$1,200/m² & Above Category)

Builder

Woh Hup (Private) Limited

Client

City Developments Limited

Principal Consultant

ONG&ONG Pte Ltd

Architectural Consultant

ONG&ONG Pte Ltd

Structural Consultant

Meinhardt (Singapore) Pte Ltd

M&E Consultant

Parsons Brinckerhoff Pte Ltd

Quantity Surveyor

Davis Langdon & Seah Singapore Pte Ltd

Construction Cost

S\$176 million

Construction Period

46 months

Gross Floor Area

100,485 m²

Key Features

- Achieved a high CONQUAS score of 95.6 for excellence in workmanship quality.
- BCA Quality Mark and Green Mark Gold^{plus} certified.
- Winner of various prestigious safety awards from 2006 to 2010 including MOM SHARP, RoSPA, BCA Design & Engineering Excellence Award, etc.
- Enhanced productivity by exploring various system formwork, precast elements, prefabricated toilet, using drywall partitions, etc.



The Metropolitan Condominium

(Residential Buildings - S\$1,200/m² & Above Category)

Builder

Nakano Singapore (Pte) Ltd

Client

Tanglin Residential Pte. Ltd. (CapitaLand Residential Singapore Pte Ltd and Lippo Group joint venture)

Principal Consultant

TSP Architects + Planners Pte Ltd

Architectural Consultant

TSP Architects + Planners Pte Ltd

Structural Consultant

SCE Consultants (Pte) Ltd

Key Features

- Demonstrated excellence for overcoming constraints of close proximity to the MRT station and line.
- Adoption of precast elements and system formwork to enhance productivity.

M&E Consultant

Alpha Consulting Engineers Pte Ltd

Quantity Surveyor

Davis Langdon & Seah Singapore Pte Ltd

Construction Cost

S\$73.1 million

Construction Period

33.5 months

Gross Floor Area

47,736 m²

★ Award



Pavilion 11 at Minbu Road

(Residential Buildings - S\$1,200/m² & Above Category)

Builder

China Construction (South Pacific) Development Co Pte Ltd

Client

UOL Development (Dakota) Pte Ltd

Principal Consultant

DP Architects Pte Ltd

Architectural Consultant

DP Architects Pte Ltd

Structural Consultant

LBW Consultants LLP

M&E Consultant

United Project Consultants Pte Ltd

Key Features

- Achieved a high CONQUAS score of 94.8 for excellence in workmanship quality.
- Demonstrated excellence by overcoming constraints of the limited working hours and safety requirements due to its proximity to a hospital and private residential buildings.
- Developed a special combined structure system comprising lift core, sheer wall and composite steel structure frame to overcome deflection of strong wind load.

Quantity Surveyor

Davis Langdon & Seah Singapore Pte Ltd

Landscape Consultant

Sitetectonix Pte Ltd

Interior Designer

DP Design Pte Ltd

Construction Cost

S\$46.5 million

Construction Period

35.2 months

Gross Floor Area

22,845 m²

★ Award



The Solitaire

(Residential Buildings - S\$1,200/m² & Above Category)

Builder

Poh Lian Construction Pte Ltd

Client

City Developments Limited

Principal Consultant

Team Design Architects Pte Ltd

Structural Consultant

KTP Consultants Pte Ltd

M&E Consultant

Squire Mech Pte Ltd

Key Features

- Enhanced safety by adopting a top-down construction method for the 4-storey basement in view of the 12m steep slope terrain.
- Extensive usage of system formwork and precast components to enhance productivity and quality.

Quantity Surveyor

Davis Langdon & Seah Singapore Pte Ltd

Construction Cost

S\$40.6 million

Construction Period

31.0 months

Gross Floor Area

11,089 m²

CONSTRUCTION EXCELLENCE AWARD

★ Award



Punggol West Contract 5

(Residential Buildings - Below S\$1200/m² Category)

Builder

Straits Construction Singapore Pte Ltd

Client

Housing & Development Board

Principal Consultant

SIPM Consultants Pte Ltd

Architectural Consultant

Surbana International Consultants Pte Ltd

Structural Consultant

Surbana International Consultants Pte Ltd

M&E Consultant

Surbana International Consultants Pte Ltd

Quantity Surveyor

Surbana International Consultants Pte Ltd

Construction Cost

S\$45.1 million

Construction Period

33.0 months

Gross Floor Area

56,342 m²

Key Features

- Winner of MOM WHO Best Practices Award 2007 and HDB Safety Award 2010 for safety performance.
- Received written compliments from surrounding homeowners.
- Demonstrated excellence by overcoming challenges such as managing the installation of precast components, which were made up of 90% precast elements.

★ Award

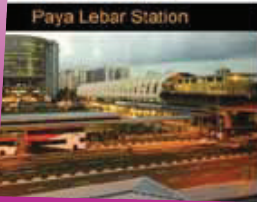

Circle Line Stage 2 Contract 823:

Construction and Completion of Stations at Old Airport Road, Tanjong Katong and Paya Lebar Including Tunnels

(Civil Engineering Projects Category)

Builder

Nishimatsu Construction Co., Ltd. / Lum Chang Building Contractors Pte Ltd Joint Venture

Client

Land Transport Authority

Principal Consultant

AECOM Singapore Pte. Ltd.

CPG Consultant Pte Ltd

Land Transport Authority

Architectural Consultant

Land Transport Authority

SAA Architects Pte Ltd

M&E Consultant

AECOM Singapore Pte. Ltd.

Land Transport Authority

Construction Cost

S\$369.0 million

Construction Period

87.5 months

Key Features

- Erected noise barriers for construction near residential blocks.
- Displayed environmental consciousness by adopting Bored Tunnelling construction in lieu of Cut and Cover Tunnelling method to minimize road diversions and noise pollution, as well as using wire saw cutting method to break out knock-out panels in diaphragm wall to minimize vibration and dust and noise pollution.

★ Award



Construction of the Marina Barrage

(Civil Engineering Projects Category)

Builder

Koh Brothers Building & Civil Engineering Contractor (Pte) Ltd

Client

Public Utilities Board, Singapore

Principal Consultant

Camp Dresser McKee International (S) Pte Ltd

Architectural Consultant

Architect Team 3 Pte

Structural Consultant

SKM Consulting Pte Ltd

M&E Consultant

Camp Dresser McKee International (S) Pte Ltd

Quantity Surveyor

Camp Dresser McKee International (S) Pte Ltd

Construction Cost

S\$250.0 million

Construction Period

46.0 months

Key Features

- Displayed excellence in interfacing works, especially for installation of the main drainage pump, crest gates and the engine generators which were designed and manufactured in three different countries.

CONSTRUCTION EXCELLENCE AWARD

★ Award



New Finger Pier To Keppel Fels Pioneer Yard

(Civil Engineering Projects Category)

Builder

Antara Koh Pte Ltd

Client

Keppel Fels Ltd

Principal Consultant

Steen Consultants Pte Ltd

Structural Consultant

Steen Consultants Pte Ltd

Construction Cost

S\$19.2 million

Construction Period

10.8 months

Key Features

- Main constraints were the tidal level and the coordination so as not to interfere with the owner's on-going operation.
- Achieved a better waterproofed concrete structure and at least one month of time-saving by precasting the underwater electric substation on a barge.



Interchange at Braddell Road/ Thomson Road/ Lornie Road

(Civil Engineering Projects Category)

Builder

Sato Kogyo (S) Pte. Ltd.

Client

Land Transport Authority

Principal Consultant

Land Transport Authority

Architectural Consultant

Land Transport Authority

Structural Consultant

T.Y. Lin International Pte Ltd

Project Manager

Land Transport Authority

Construction Cost

S\$36.3 million

Construction Period

41.0 months

Key Features

- Demonstrated excellence by overcoming safety and environmental constraints due to its proximity to hospital, schools and residential buildings.
- Low vibration bored piling was adopted for all piling within 100m from hospital to minimize vibration.



Proposed Gateway Avenue Roadworks Diversion for Resorts World at Sentosa Pte Ltd

(Civil Engineering Projects Category)

Builder

Gammon Pte. Limited

Client

Public Utilities Board, Singapore

Principal Consultant

AECOM Singapore Pte Ltd

Architectural Consultant

DP Architects Pte Ltd

Structural Consultant

AECOM Singapore Pte Ltd

M&E Consultant

Meinhardt (Singapore) Pte Ltd

Quantity Surveyor

DLS-KPK IR Pte Ltd

Construction Cost

S\$60.0 million

Construction Period

13.5 months

Key Features

- Commendable in its careful planning and construction of the 32m by 17m underground storm water chamber with an underpass ramp.
- Demonstrated excellence by overcoming time and working space constraints with careful planning and coordination for layering of the multi-levels underground services.

★ Award

CONSTRUCTION EXCELLENCE AWARD

★ Merit



11 Tampines Concourse

(Commercial / Mixed Development Buildings Category)

Builder

Dragages Singapore Pte Ltd

Client

City Developments Limited

Architectural Consultant

Architects 61 Pte Ltd

Structural Consultant

LSW Consulting Engineers Pte Ltd

M&E Consultant

Conteem Engineers Pte Ltd

Quantity Surveyor

KPK Quantity Surveyors (Singapore) Pte Ltd

Construction Cost

S\$29.5 million

Construction Period

13.0 months

Gross Floor Area

11,500 m²

★ Merit



City Square Mall

(Commercial / Mixed Development Buildings Category)

Builder

Kajima Overseas Asia Pte Ltd

Client

City Developments Limited

Principal Consultant

ONG&ONG Pte Ltd

Architectural Consultant

ONG&ONG Pte Ltd

Structural Consultant

Meinhardt (Singapore) Pte Ltd

M&E Consultant

Parsons Brinckerhoff Pte Ltd

Quantity Surveyor

Davis Langdon & Seah Singapore Pte Ltd

Design & Retail Consultant

Lend Lease

Construction Cost

S\$191.6 million

Construction Period

34.0 months

Gross Floor Area

65,542 m²

CONSTRUCTION EXCELLENCE AWARD

★ Merit

Hong Kah Secondary School

(Institutional Buildings Category)

Builder

Santarli Construction Pte Ltd

Client

Ministry of Education

Architectural Consultant

CPG Consultants Pte Ltd

Structural Consultant

CPG Consultants Pte Ltd

M&E Consultant

CPG Consultants Pte Ltd

Quantity Surveyor

CPG Consultants Pte Ltd

Project Manager

PM Link Pte Ltd

Construction Cost

S\$28.1 million

Construction Period

15.4 months

Gross Floor Area

23,191 m²



★ Merit

Sungei Gedong Camp Redevelopment Phase 2

(Institutional Buildings Category)

Builder

Ho Lee Construction Pte Ltd

Client

Defence Science and Technology Agency

Principal Consultant

JGP Architecture (S) Pte Ltd

Architectural Consultant

JGP Architecture (S) Pte Ltd

Structural Consultant

JY Consultants Pte Ltd

M&E Consultant

J Roger Preston (S) Pte Ltd

Construction Cost

S\$45.5 million

Construction Period

30.0 months

Gross Floor Area

58,943 m²



★ Merit

Al-Mawaddah Mosque

(Institutional Buildings Category)

Builder

Khian Heng Construction (Pte) Ltd

Client

Majlis Ugama Islam Singapura

Architectural Consultant

Park + Associates Pte Ltd

Structural Consultant

K P Chai Engineering & Management Consultants

M&E Consultant

Lincolne Scott Ng Pte Ltd

Quantity Surveyor

CPG Consultants Pte Ltd

Project Manager

Warees Investments Pte Ltd

Acoustic Consultant

DAS International

Construction Cost

S\$10.9 million

Construction Period

18.0 months

Gross Floor Area

3,483 m²



CONSTRUCTION EXCELLENCE AWARD

★ Merit



Botannia Condominium

(Residential Buildings - S\$1,200/m² & Above Category)

Builder

Hyundai Engineering
& Construction Co., Ltd

Client

City Developments Limited /
Leonie Court -Botannia Joint
Venture

Principal Consultant

MKPL Architects Pte Ltd

Architectural Consultant

MKPL Architects Pte Ltd

Structural Consultant

LSW Consulting Engineers Pte Ltd

M&E Consultant

Beca Carter Hollings & Ferner
(S.E. Asia) Pte Ltd

Quantity Surveyor

Davis Langdon & Seah Singapore
Pte Ltd

Construction Cost

S\$114.8 million

Construction Period

37.0 months

Gross Floor Area

60,556 m²

★ Merit



Buckley 18

(Residential Buildings - S\$1,200/m² & Above Category)

Builder

Poh Lian Construction Pte Ltd

Client

Hong Realty Pte Ltd

Architectural Consultant

Axis Architects Planners Pte Ltd

Structural Consultant

KTP Consultants Pte Ltd

M&E Consultant

Technocon Engineers (S) Pte Ltd

Quantity Surveyor

Davis Langdon & Seah Singapore
Pte Ltd

Construction Cost

S\$24.8 million

Construction Period

26.0 months

Gross Floor Area

7,559 m²

★ Merit



The Tate Residences

(Residential Buildings - S\$1,200/m² & Above Category)

Builder

Woh Hup (Private) Limited

Client

Hong Leong Holdings Limited

Principal Consultant

DP Architects Pte Ltd

Structural Consultant

KTP Consultants Pte Ltd

M&E Consultant

Belmacs Pte Ltd

Quantity Surveyor

Davis Langdon & Seah Singapore
Pte Ltd

Landscape Architect

Tierra Design (Singapore)

Façade Consultant

Arup Singapore Pte Ltd

Construction Cost

S\$78.2 million

Construction Period

38.0 months

Gross Floor Area

21,021 m²

CONSTRUCTION EXCELLENCE AWARD

★ Merit



Building Works at Sembawang Neighbourhood 4 Contract 15

(Residential Buildings - Below S\$1200/m² Category)

Builder

Chip Eng Seng Contractors (1988)
Pte Ltd

M&E Consultant

Surbana International Consultants
Pte Ltd

Client

Housing & Development Board

Quantity Surveyor

Surbana International Consultants
Pte Ltd

Principal Consultant

Surbana International Consultants
Pte Ltd

Construction Cost

S\$51.3 million

Architectural Consultant

Surbana International Consultants
Pte Ltd

Construction Period

27.0 months

Structural Consultant

Surbana International Consultants
Pte Ltd

Gross Floor Area

63,720 m²

★ Merit



Punggol West Contract 6

(Residential Buildings - Below S\$1200/m² Category)

Builder

Straits Construction Singapore
Pte Ltd

M&E Consultant

Surbana International Consultants
Pte Ltd

Client

Housing & Development Board

Quantity Surveyor

Surbana International Consultants
Pte Ltd

Principal Consultant

SIPM Consultants Pte Ltd

Construction Cost

S\$48.2 million

Architectural Consultant

Surbana International Consultants
Pte Ltd

Construction Period

33.0 months

Structural Consultant

Surbana International Consultants
Pte Ltd

Gross Floor Area

48,861 m²

★ Merit



Contract 1- Punggol Reservoir: Dams, Gates, Dredging and Ancillary Works

(Civil Engineering Projects Category)

Builder

Shimizu Corporation

M&E Consultant

CPG Consultants Pte Ltd

Client

Public Utilities Board, Singapore

Quantity Surveyor

CPG Consultants Pte Ltd

Principal Consultant

CPG Consultants Pte Ltd

Construction Cost

S\$70.2 million

Architectural Consultant

CPG Consultants Pte Ltd

Construction Period

34.0 months

Structural Consultant

CPG Consultants Pte Ltd